

James Gill

A. 24. 99

A. 24. 100

John Gill

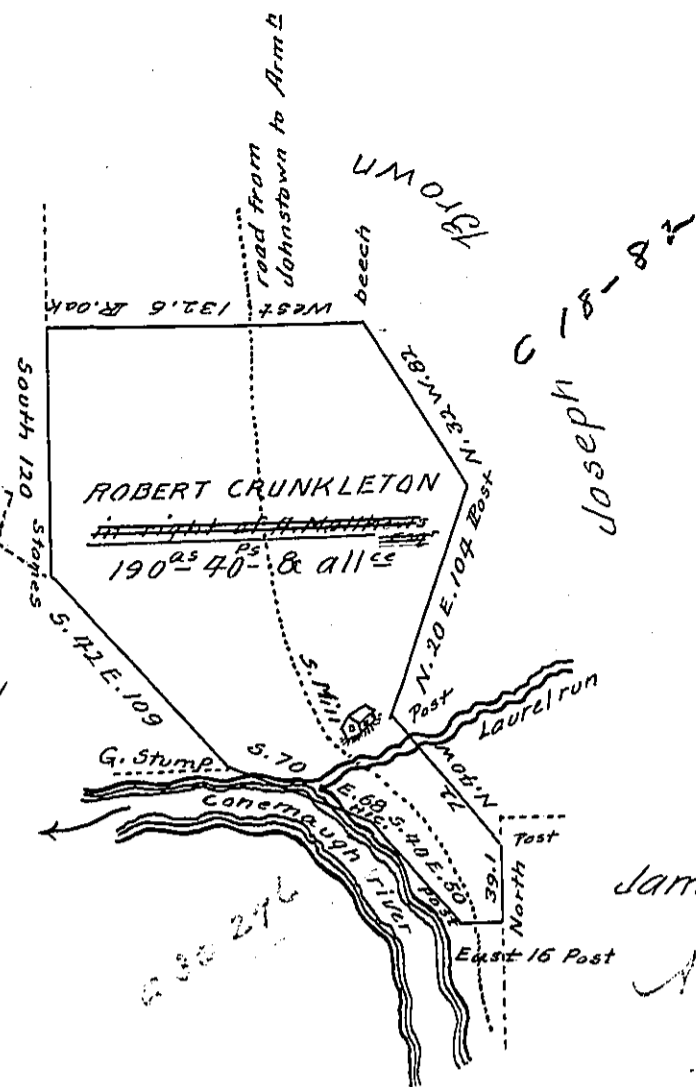

James Montgomery

A. 25. 1814

Situate on the North side of Conemaugh river in Conemaugh Township Cambria County on the East side of Laurel hill on the waters of Laurel run including its mouth Containing one hundred and ninety acres, forty perches and the usual allowance of Six per cent- Surveyed on the 13<sup>th</sup> Day of April A.D. 1829 for Archebald Matthews Esq<sup>r</sup> in pursuance of a Warrant granted to Robert Crunkleton on the 1<sup>st</sup> day of Nov<sup>r</sup> A.D. 1785- for 200-

the land is improved for a number of years back

Stephen Lloyd D. S.

To Gab<sup>l</sup> Heister Esq<sup>r</sup>

Surveyor General

IN TESTIMONY that the above is a copy of the original remaining on file in the Department of Internal Affairs of Pennsylvania, made conformably to an Act of Assembly approved the 16th day of February, 1833, I have hereunto set my Hand and caused the Seal of said Department to be affixed at Harrisburg, this thirteenth day of May 1904

*Isaac P. Brown*  
Secretary of Internal Affairs.